

Sug. Loaf -
Luzerne.

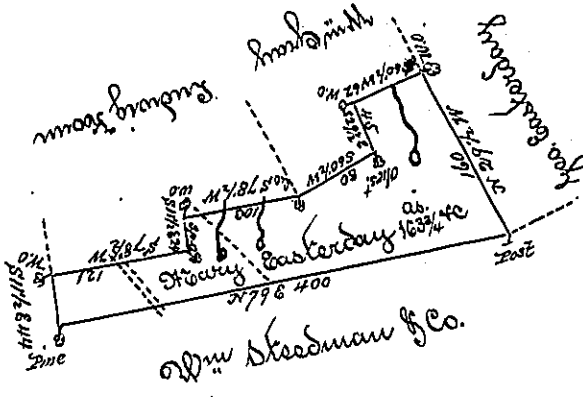

A Draft of a tract of land called _____ situate in the County of Luzerne
 Containing one Hundred and sixty three acres $\frac{3}{4}$ & allots surveyed for Henry
 Easterday the 23^d Day of Dec^r 1793 by virtue of a Warrant dated the 26th Day
 of Dec^r 1793.

So Daniel Brodhead Esq. }
 Sur^r Genl }

by Wm. Gray D. S.

IN TESTIMONY that the above is a copy of the original remaining on file in the
 Department of Internal Affairs of Pennsylvania, made con-
 formably to an Act of Assembly approved the 16th day of
 February, 1833, I have hereunto set my Hand and caused
 the Seal of said Department to be affixed at Harrisburg, this
 fifth _____ day of _____ October _____ 1897.

James W. Patton
 Secretary of Internal Affairs.